



## GlowLine Flex Top

DN196003



**Warranty**  
2 Year Warranty

**Control**  
Standard DMX512 control protocol (Max 44 frames / second).  
The communication between fittings can be synchronised perfectly under use of Titan ArtNet Controller.

**Protection**  
Lightning and ESD Protection  
Electrical Protections: short circuit, over current, over voltage and over temperature.

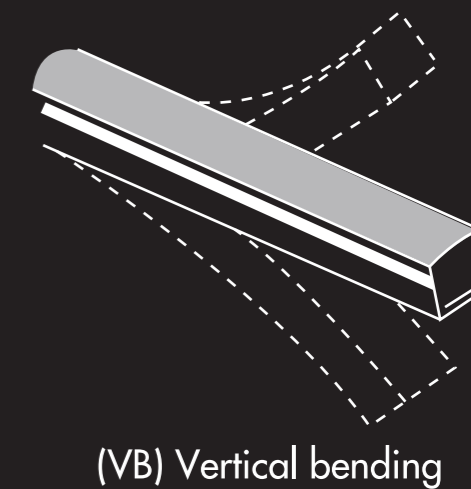
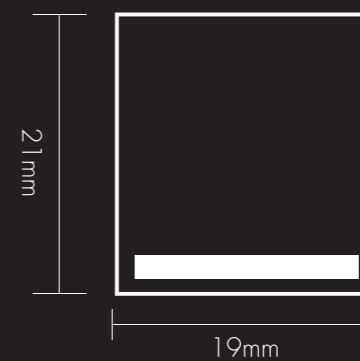
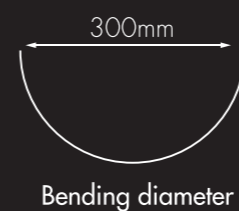

## Dimension

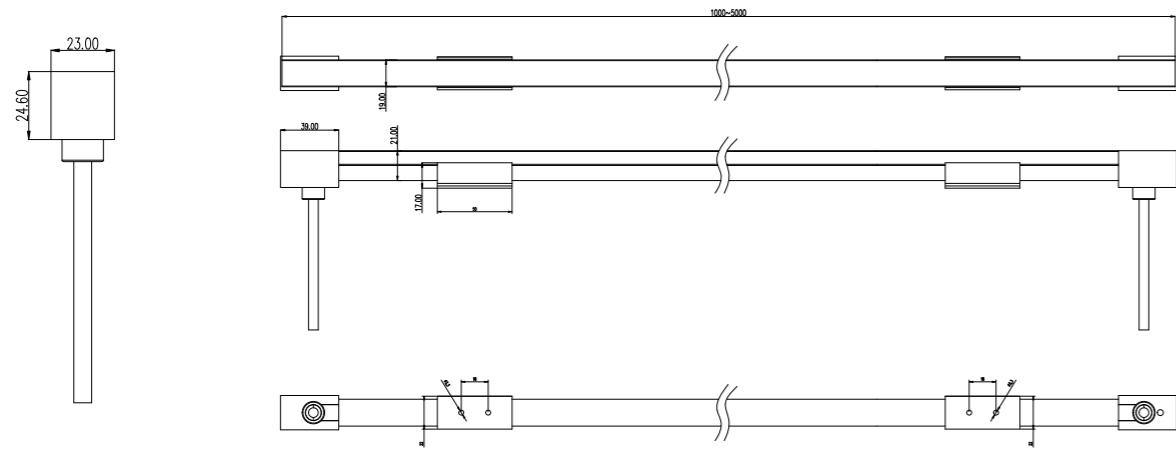

### Colors

DN196001

DN196003

DN196004



### LED

LED Source	Epistar 5050	Epistar RGB 5050	Epistar RGBW 5050
LED QTY	60pcs		
Beam Angle	120°		

### Electrical

Input voltage	24VDC		
power consumption	12W per meter	12W per meter	18W per meter

### Control

Protocol	DMX512
Pixels	10 pixels per meter
Addressing options	Manual addressing

### Physical

Housing Material	Silicone	Mounting Options	Surface mount
Finish	White	Luminaire Connection	4PIN cable with screw lock connector for DC and DMX
Lense	Opal		

### Environment

Operating Temperature	-30° to 60°	Humidity	0-95%,non-condensing
Startup Temperature	-30° to 60°	IP	Outdoor IP66
Storage Temperature	-40° to 80°		

### Certificate



## Ordering Information

Product	Width	LED QTY	LED Color
<b>DN</b>	<b>19</b>	<b>60</b>	<b>03</b>
DMX Neon	19mm Wide	60LEDs per meter	01 White 03 RGB 04 RGBW

## Accessories

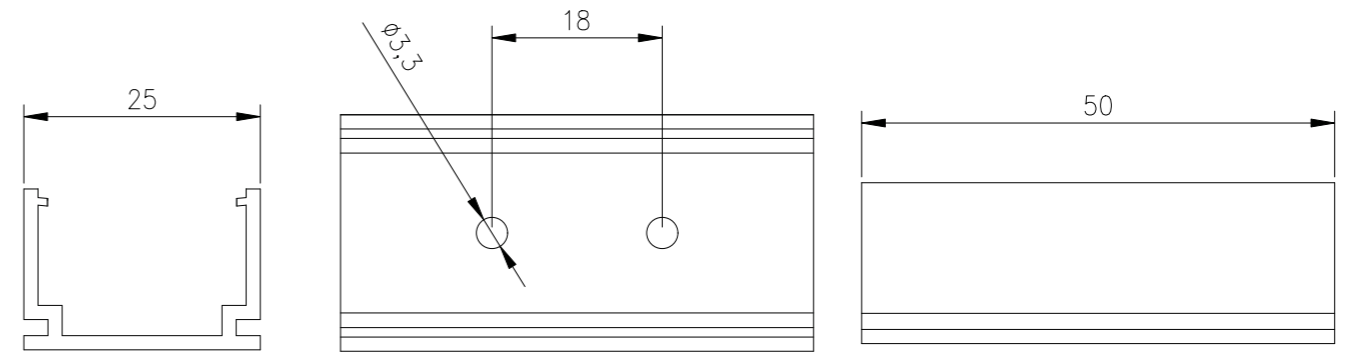

## Wiring diagram

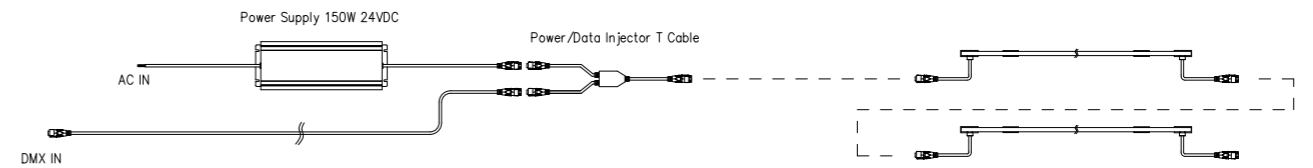

### Luminair Interconnection

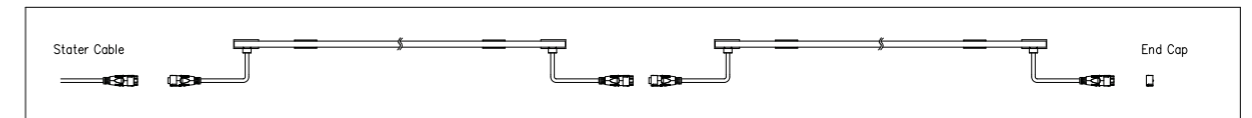

### Maximim Run Lengths

	60LEDs 12W Per meter(RGB)	60LEDs 18W Per meter(RGBW)
24VDC	up to 15meter	up to 10meter